

# PRODUCT DATA SHEET



## LİNEER LED RK-1000 SERIES



### LUMINARE DETAILS

HOUSING  
PMMA cover  
Aluminium eloxal body

VOLTAGE  
24 VDC

### COLOR TEMPERATURE

2700 K  
3000 K  
4000 K  
5000 K

### COVER TYPE

Clear CO  
Opal MO

### MOUNTING

Surface mounted

### APPLICATIONS

Indoors

### CONTROL SYSTEM

1-10V  
DALI  
ON/OFF

### OPTIONAL ACCESSORIES

Power supply  
Emergency Kit



3000K



4000K



5000K



IP40



III

RoHS



F

CE

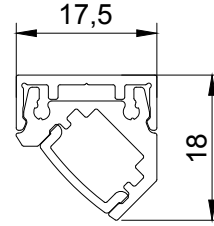

RK 1000 SERIES					
ORDER CODE	LED/MT	LED	LUMEN/MT	POWER CONSUMPTION	IP RATE
RK-1100.01	24 LED/MT	5630	800 LM/MT	10 W/MT	IP 40
RK-1100.02	36 LED/MT	5630	1200 LM/MT	14 W/MT	IP 40
RK-1100.03	48 LED/MT	5630	1600 LM/MT	18 W/MT	IP 40
RK-1100.04	60 LED/MT	5630	2000 LM/MT	24 W/MT	IP 40
RK-1200.01	60 LED/MT	3014	440 LM/MT	6 W/MT	IP 40
RK-1200.02	72 LED/MT	3014	520 LM/MT	8 W/MT	IP 40
RK-1200.03	120 LED/MT	3014	840 LM/MT	12 W/MT	IP 40
RK-1200.04	160 LED/MT	3014	1200 LM/MT	16 W/MT	IP 40